

General

1. Number of Phase	2 (PM Type)
2. Excitation Mode	2-2
3. Step Angle	7.5°±5% (No Load)
4. Operating Temp. Range	-10℃~+50℃
5. Dielectric Strength	AC500V (1 min.)
6. Insulation Res.	100MΩ (DC500V)
7. Insulation Class	E
8. Max. Operating Temp.	+100℃ (At the case)
9. Res. Per Winding	120Ω±7%
10. Ind. Per Winding	37mH (1Vrms. 1KHz)
11. Starting Pulse Rate	770pps (No Load)
12. Slewing Pulse Rate	900pps (No Load)
13. Holding Torque	10.0mN·m (Average)
14. Temp. Rise (Res. Method)	70K (0pps)
15. Mass	35g
16. Rotor Moment of Inertia	1.0×10 ⁻⁷ kg·m ²
17. Ambient Temp. Range	See No.8 (Operating)
18. Operating Humidity	RH85% (Non Dewdrop)
19. Ambient Temp. Range	-30℃~+80℃ (Storage)

Remarks

1. No. 9 to 13 are tested at the rated voltage (13.3V ±2%) and the environment is normal temp. (20℃ ±5℃), humidity range (65% ±20%).
2. No. 13, Dynamic Torque characs are value by using torque meter.
3. The Driver is PS-1LD-42 (for Unipolar,including of 2SD633). It does not include Serge-Killer circuits,(Back-Electromotive -suppress circuits).
4. When the rated voltage is 13.3V, the terminal voltage is 12.5V.

Dynamic Torque characteristics
(Pull-in; calculate (No load))

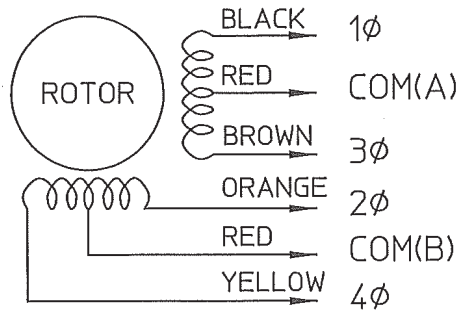
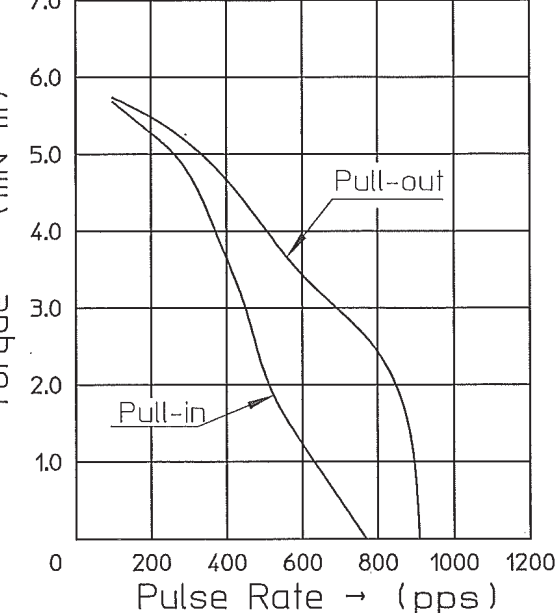

Direction of rotation viewed from shaft End.

No.	BLK	BRN	ORN	YLW	No.
1	ON	OFF	ON	OFF	4
2	OFF	ON	ON	OFF	3
3	OFF	ON	OFF	ON	2
4	ON	OFF	OFF	ON	1

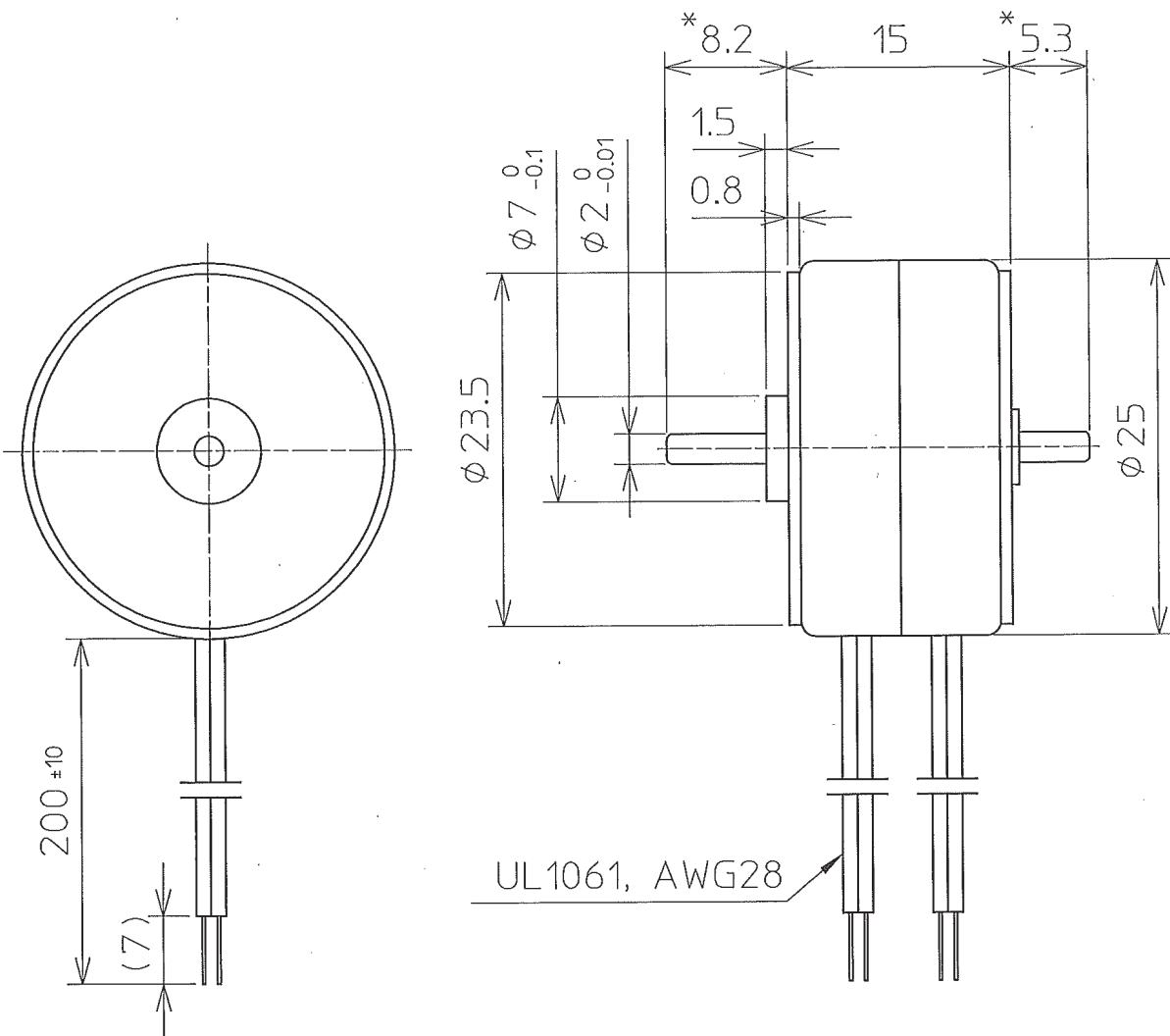

Note

1. Tolerance:±0.5, ±5°
2. However, it should be noted that * indicates dimension where the shaft being pressed toward motor-side.
3. End Play : 0.5 Max.
Radial Play : 0.05 Max.
4. Max. Axial Force : 50N
5. Strength : 100N (Case to plate)
6. This motor is RoHS compliant.
"R" will appear on the end of the lot number.
"RoHS" will appear on the package.

△			Scale	Third	Name	PF25-48C1-24
△			2/1	Angle		
△				Projection	Dimensions(mm)	K006837